

TAIL TRAIL

Can you help Riley Ratcliffe, a city rat? Help her find her relatives around the museum to complete this family tree.

Write the names of her ancestors on the branches, and choose your favourite fact from each display or gallery to create a keepsake for you and Riley.

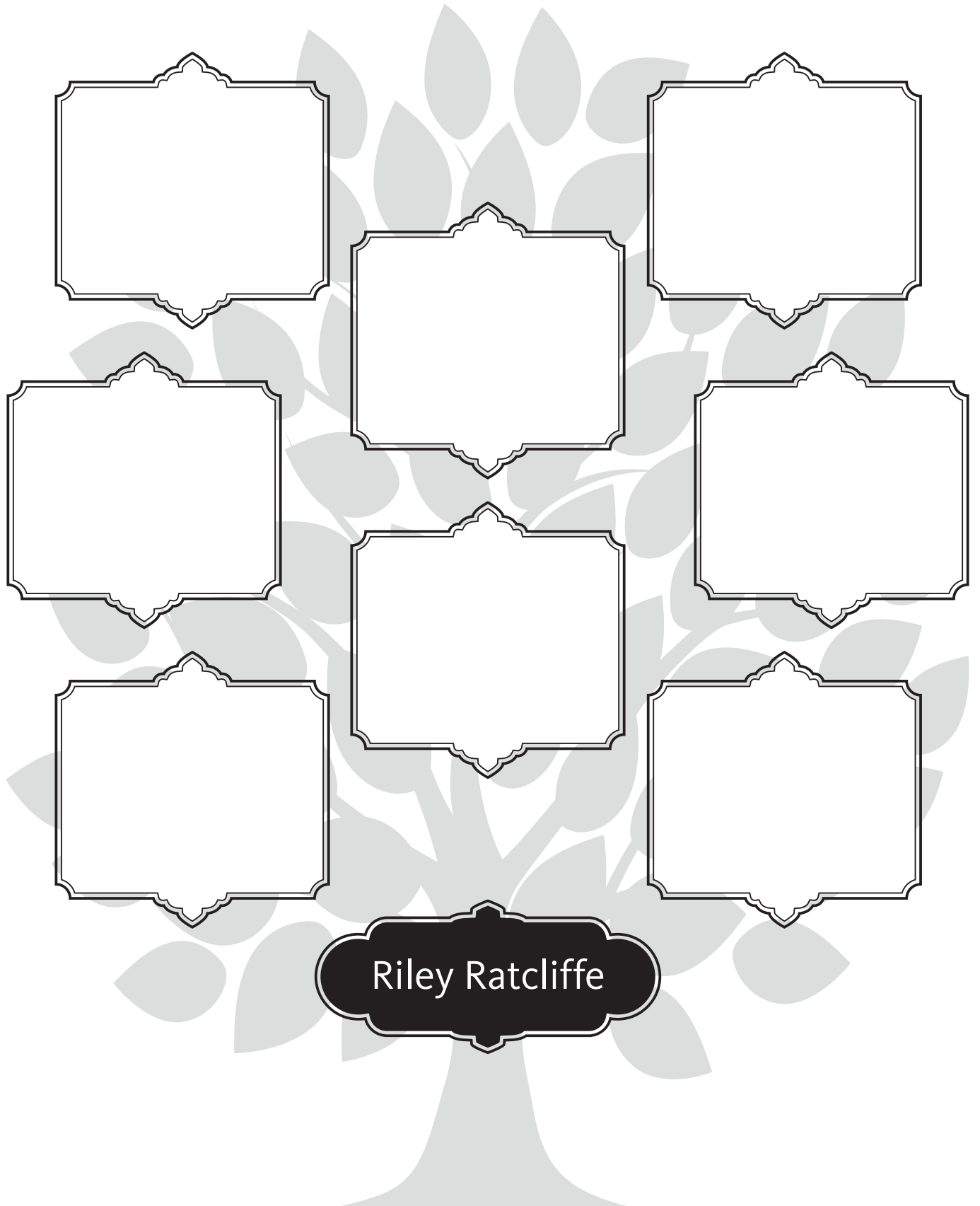

Use this map to help you make your way around the galleries.

Find a member of the museum team before you leave and tell us how you got on!



Having trouble finding our furry friends? Use these clues to help you.

3

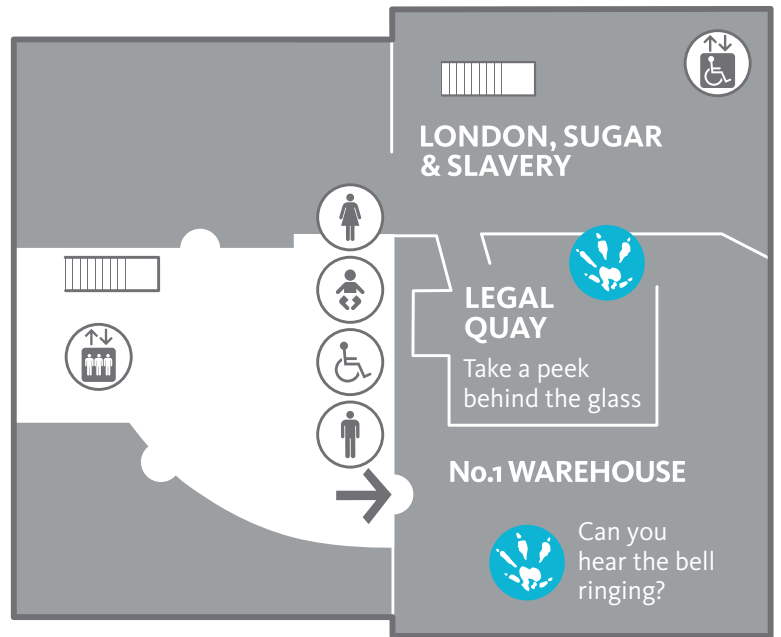
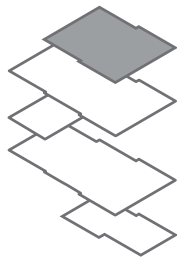

2

